

Accessories: Skid Plate Accessory (10-08333)

Fits Motorcycles: 23 MY: DSR/X

Overview

This document provides installation instructions for installing the (10-08333) skid plate on the motorcycles listed above.

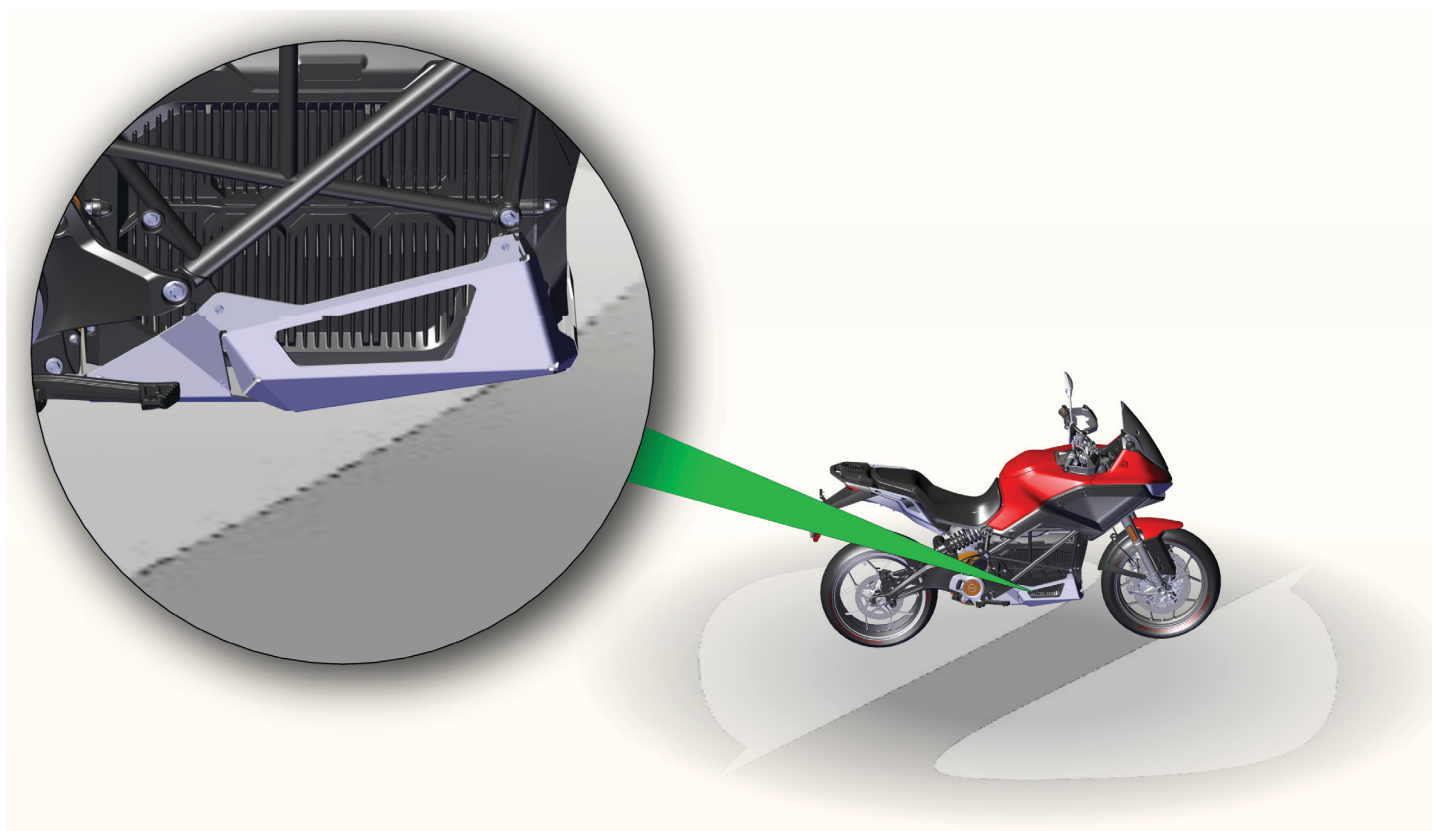

Required Parts

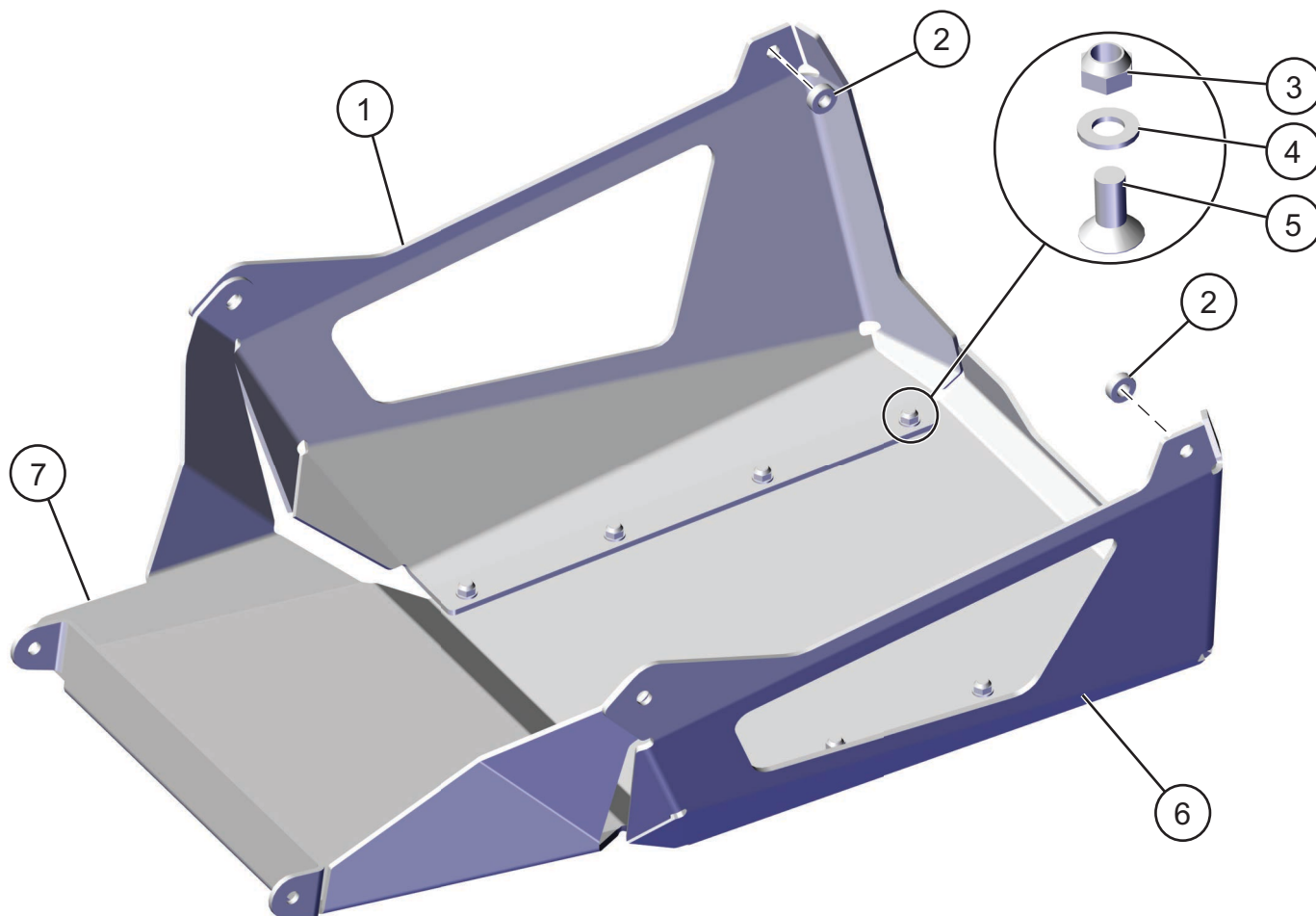

Item	Part Number	Skid Plate Accessory (10-08333)	Quantity
1	26-08538	Left skid plate	1
2	26-08558	Spacer	2
3	90-02053	Locknut - M5	8
4	90-02101	Washer	8
5	90-05244	Countersunk head screw - M5 x 12	8
6	26-08539	Right skid plate	1
7	26-08537	Center skid plate	1

Installation

1. Remove the three screws that secure the RH dust cover and remove the cover.

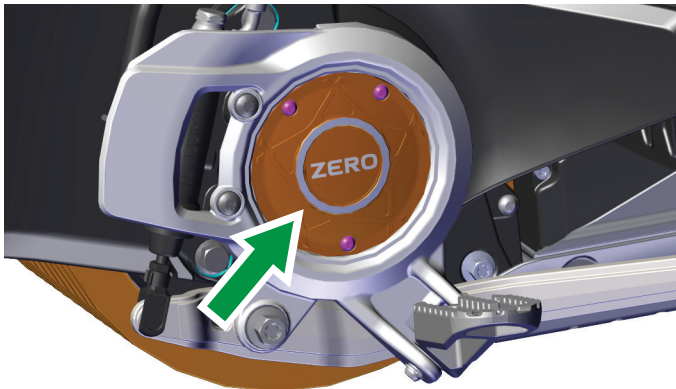

Figure 1

2. Remove the three bolts that secure the peg mount assembly.

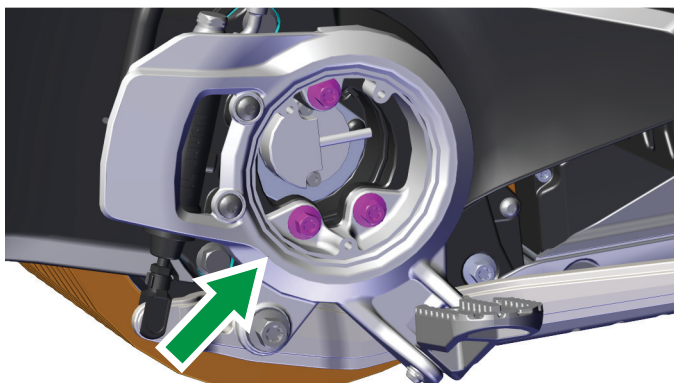

Figure 2

3. Remove the six bolts that secure the existing skid plate to the motorcycle. Set the bolts aside for reuse.

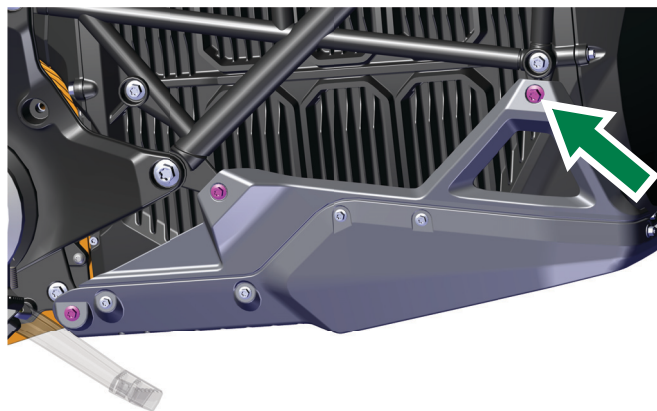

Figure 3

4. Bolt LH skid plate (1) to center skid plate (7) using four screws (5), washers (4) and locknuts (3).

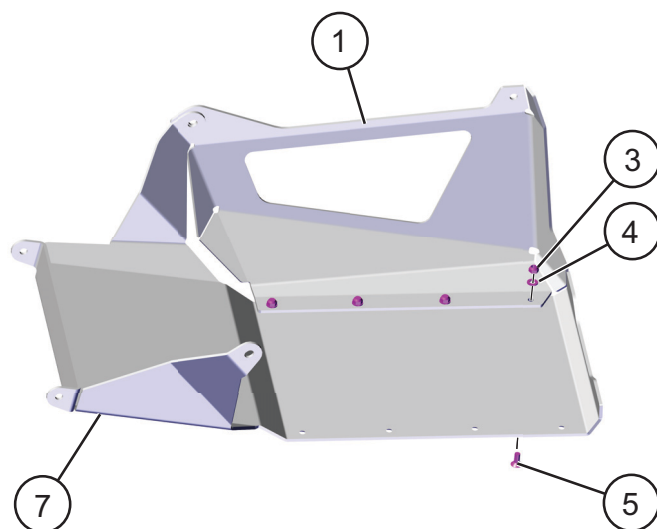

Figure 4

5. Bolt RH skid plate (6) to center skid plate (7) using four screws (5), washers (4) and locknuts (3).

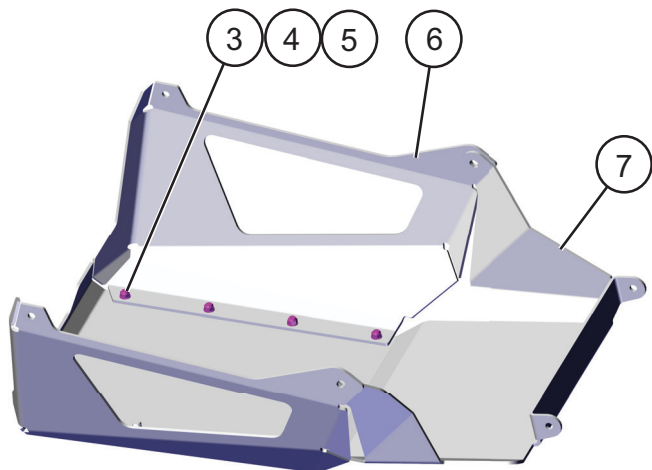

Figure 5

6. Bolt the assembly to the bike in six places using the existing bolts. Install spacer (2) at the front-most mounting location on each side.
 - Torque to 7 ft lb (9 Nm)

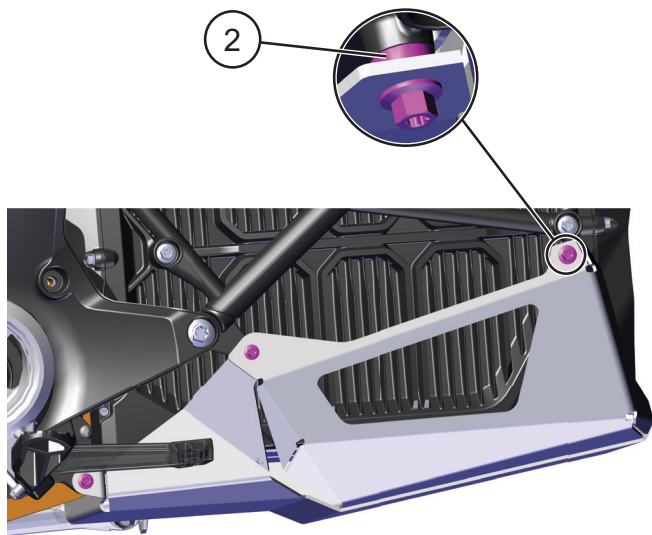

Figure 6

7. Bolt the peg mount assembly to the chassis.
 - Torque to 25 ft lb (34 Nm)

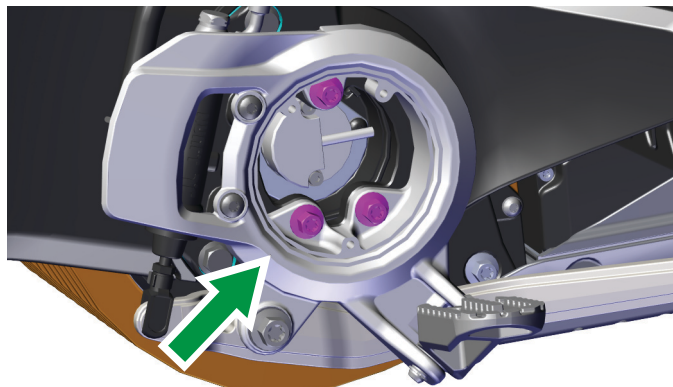

Figure 7

8. Install the dust cap.

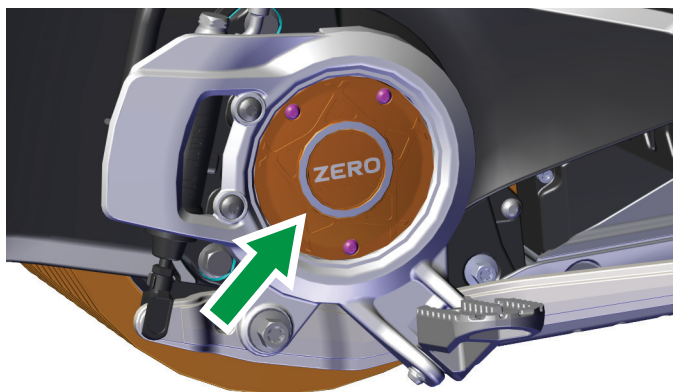

Figure 8