

**Accessories:** Top Case Mount (10-08341), Top Case (24-08543)

**Fits Motorcycles:** 23MY DSR/X

## Overview

The top case and mount kit adds a storage case onto the rear of the seat tray on the motorcycles listed above.



### Required Parts

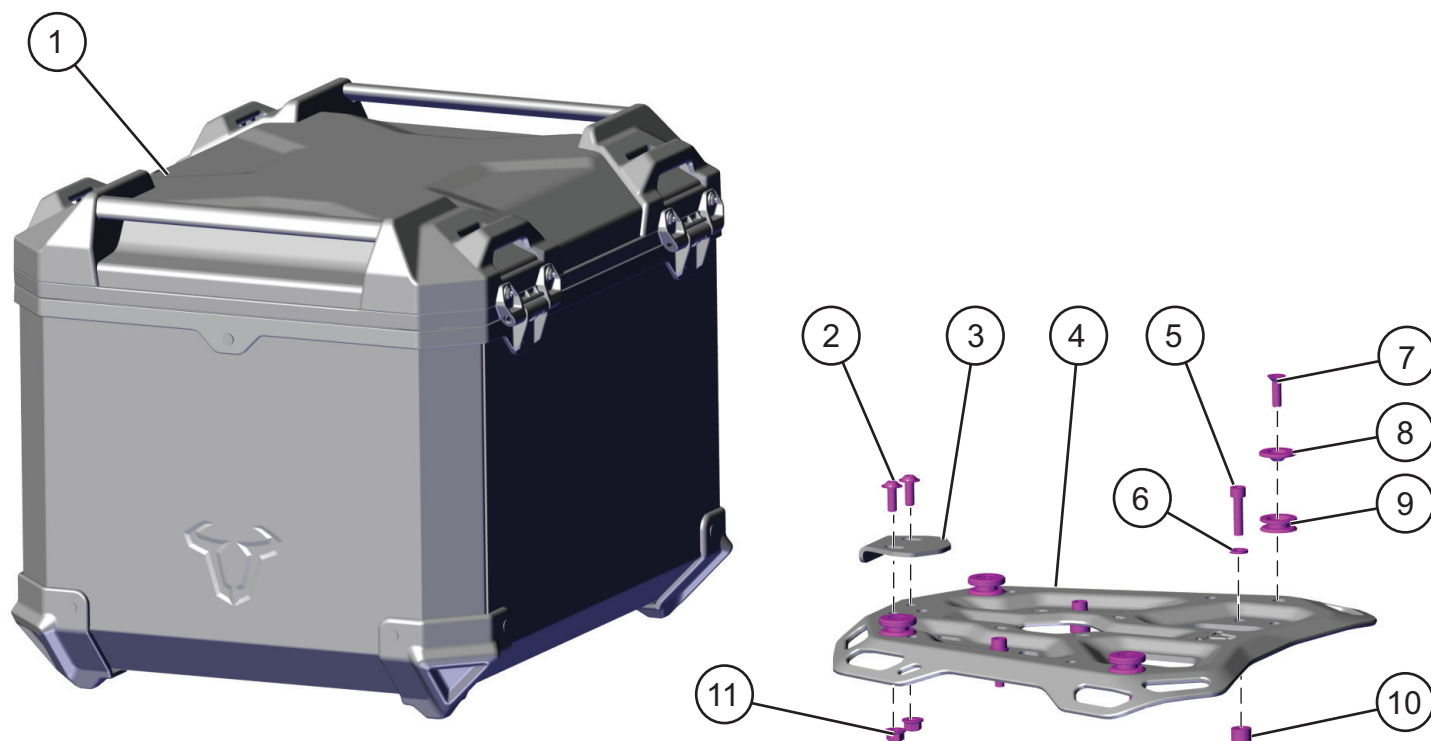

Item	Part Number	Top Case and Mount	Quantity
1	24-08543	Top case	1
-	10-08341	Top case mount kit	1
2	-	• Button head screw	2
3	-	• Latch hook	1
4	-	• Mounting bracket	1
5	-	• Socket head capscrew	4
6	-	• Washer	4
7	-	• Countersunk screw	4
8	-	• Sleeve	4
9	-	• Spool	4
10	-	• Spacer	4
11	-	• Nut	2

### Installation

1. Attach latch hook (3) onto bracket (4) using two button head screws (2) and nuts (11).

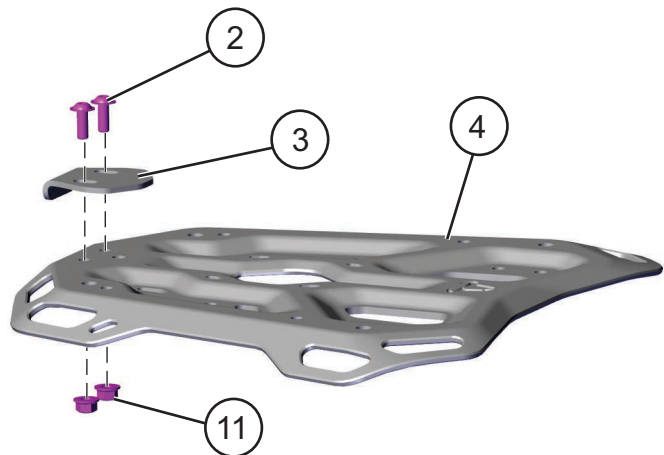

Figure 1

*Note: Do not tighten the screws at this time. The latch hook has slotted holes for adjustment that will be adjusted later in this procedure.*

2. Position four spacers (10) onto the seat tray as shown. There are four bosses on the tray to accept the spacers.

*Note: If installed, remove any existing screws from these locations before placing the spacers into position.*

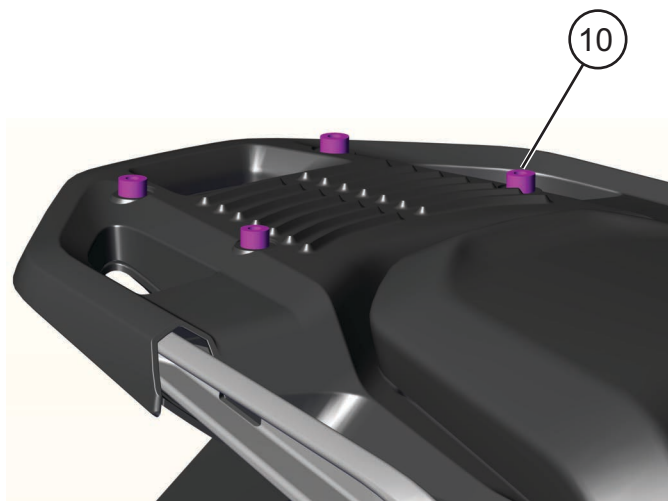

Figure 2

3. Install bracket (4) onto the seat tray using four socket head capscrews (5) and washers (6).

*Note: Apply Loctite Blue 242 to the threads of the screws.*

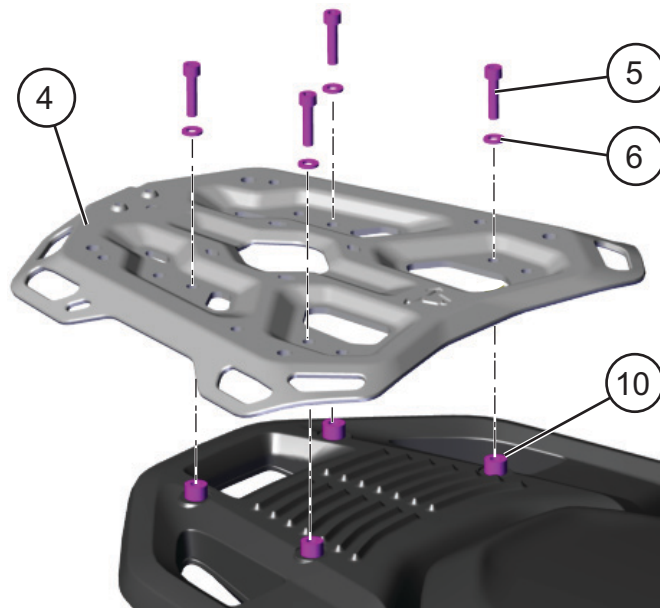

Figure 3

4. Install four spools (9), sleeves (8) and counter-sunk screws (7) onto the mounting bracket in the locations shown.

- Torque to 7 ft lb (9 Nm)

*Note: Apply Loctite Blue 242 to the threads of the screws.*

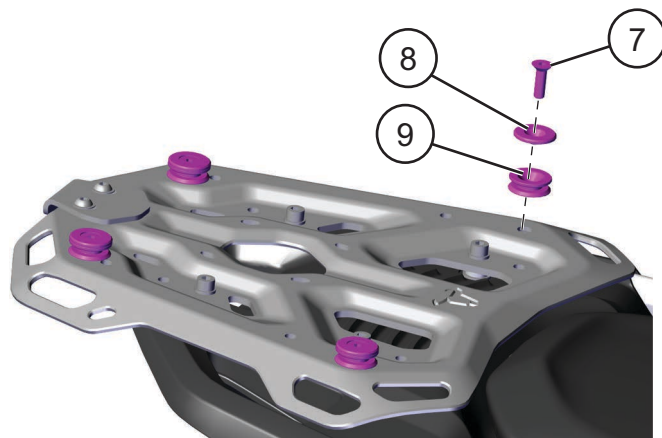

Figure 4

5. Lift the top case over the spools and lower into place. Slide the case forward until the case locks onto the spools.



Figure 5

6. Secure the rear latch onto the mounting bracket.



Figure 6

7. Adjust the latch hook in or out to ensure the latch is properly attached and the case is secure with no play.

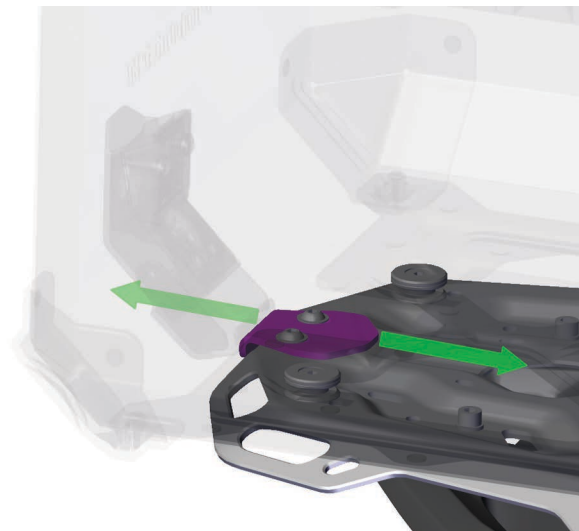

Figure 7